

Subject: MIL ILLUMINATION WITH DTC P2135	Bulletin No: 01-016/06
	Last Issued: 05/18/2006

APPLICABLE MODEL(S)/VINS

2003 - 2005 Mazda6 3.0L

DESCRIPTION

Some vehicles may experience a MIL illumination with DTC P2135 stored in memory.

Customers having this concern should have their vehicle repaired using the following repair procedure.

REPAIR PROCEDURE

1. Verify DTC P2135 is stored in memory.
2. Open hood and locate throttle body.

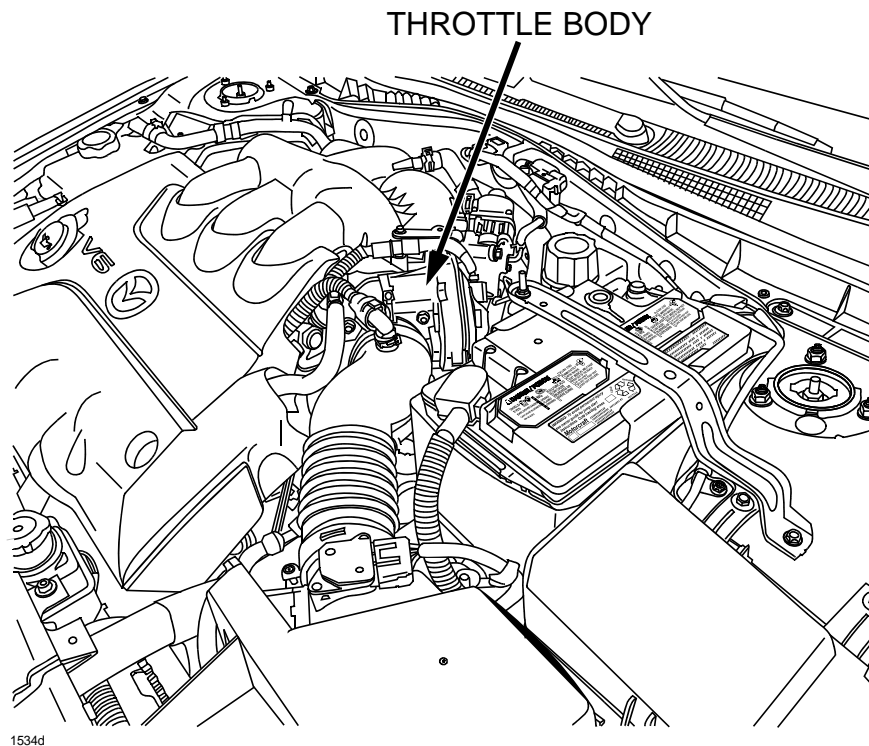

3. Inspect letters on throttle body as shown below.

THROTTLE BODY

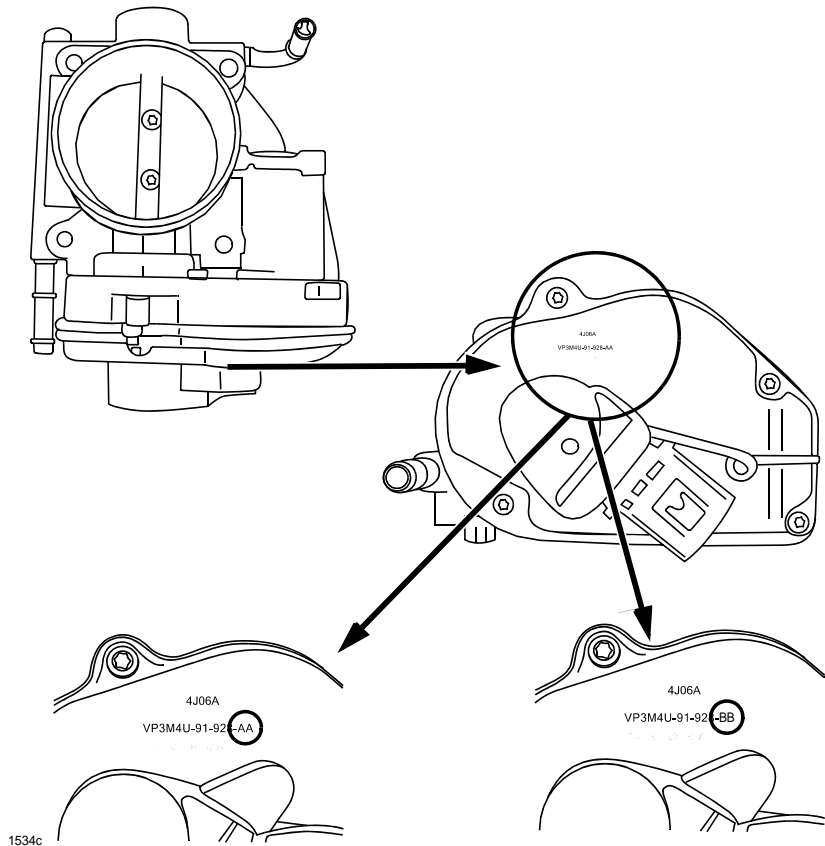

AA, AB, BA MARKINGS = NO GOOD BB MARKING = GOOD

- If letters "AA", "AB", or "BA" are found on the throttle body, proceed to Step 4.
 - If letters "BB" is found on the throttle body, troubleshoot DTC according to the Workshop Manual.
4. Record customer's preset radio stations.
 5. Disconnect negative battery cable.
 6. Replace throttle body according to Workshop Manual (section 01-13 INTAKE AIR SYSTEM REMOVAL/ INSTALLATION [AJ]).
 7. Reconnect negative battery cable.
 8. Erase DTC.
 9. Re-enter customer's preset radio stations.
 10. Verify repair.

Bulletin No: 01-016/06
© 2006 Mazda Motor of America, Inc.

Last Issued: 05/18/2006

PART(S) INFORMATION

Part Number	Description	Qty.	Notes
AJTT-13-640	Throttle Body	1	"BB" Marking = Good Part

WARRANTY INFORMATION

NOTE:

- This warranty information applies only to verified customer complaints on vehicles eligible for warranty repair. Refer to the Warranty Wizard for warranty term information.
- Additional diagnostic time cannot be claimed for this repair.

Warranty Type	A
Symptom Code	62
Damage Code	9W
Part Number Main Cause	AJTT-13-640
Quantity	1
Operation Number / Labor Hours:	YY431XRX / 0.9 Hr.